



FUKOKU SEIMEI BLDG. 富国生命ビル

Links directly to Uchisaiwaicho Station on the Toei Mita Line, where the central government offices, Supreme Court and headquarters of major corporations converge. Stands adjacent to Hibiya Park as an elegant and stately landmark surrounded by lush greenery.

Introducing the Fukokuseimei Building.

LOCATION

Situated in Uchisaiwaicho in the heart of Tokyo, the Fukokuseimei Building lies within reach of Kasumigaseki, the site of the central government and Supreme Court, the brand boutique-lined streets of Ginza and the rich culture and greenery of the Hibiya district.



SHOP & RESTAURANT

To comfortably support the daily routines of building workers, the Fukokuseimei Building features 30 service-oriented stores and restaurants spread across 1F, 28F and B2F. The Fukokuseimei Building links directly with the basement levels of multiple neighboring buildings to form a commercial zone rich in variety and charm.

CONFERENCE

The spacious meeting room located on 28F accommodates between 20 and 180 guests and is available for small and large meetings, conferences, lectures and other events to support the business activities of building workers.

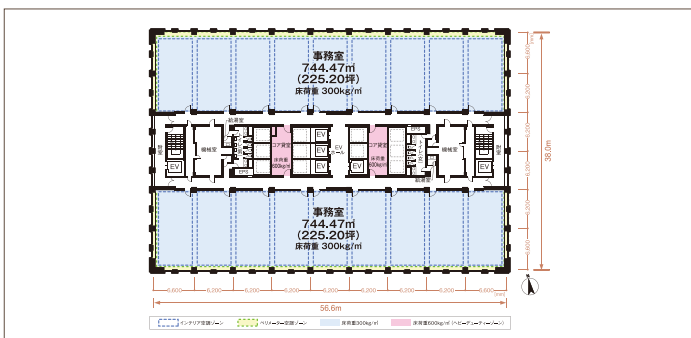

STANDARD FLOOR

Spaces at the north and south sections on each floor are 744.47m² in area (total of 1,488.94m² for each floor) and are easy-to-use by the column-less and regular configuration. The spaces can be divided minimal 25 tsubo (82.50m²) in area.